

**ULINE**

**HEAVY-DUTY STEEL  
SHELVING – 96" WIDE**

1-800-295-5510  
uline.com

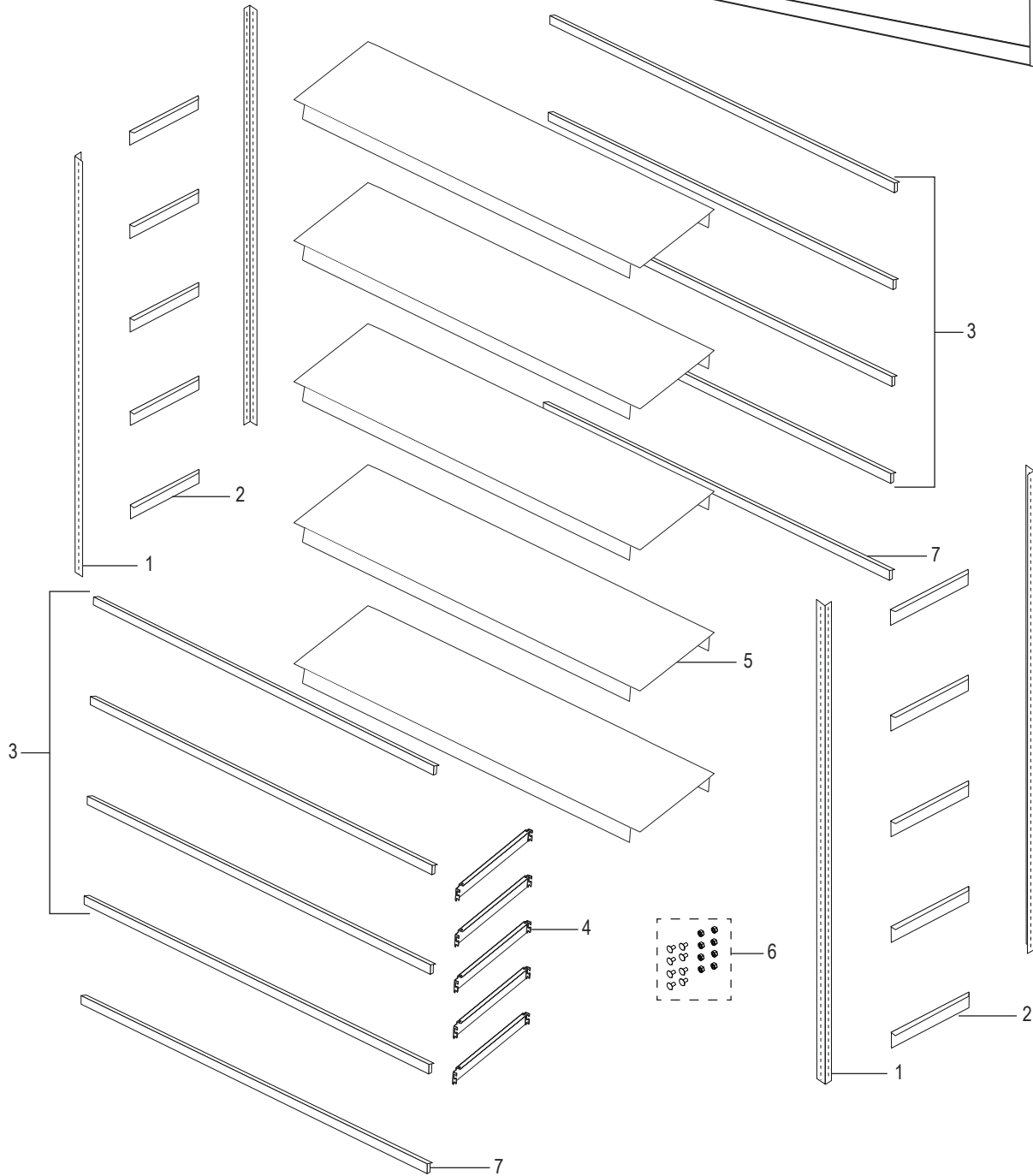

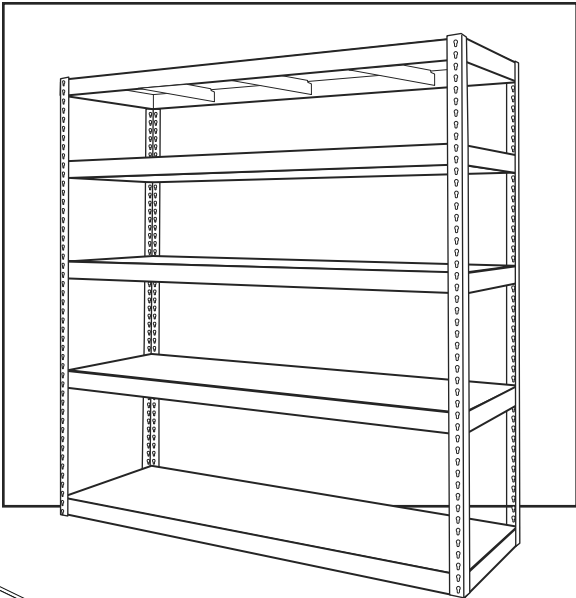

# HEAVY-DUTY STEEL SHELVING – 96" WIDE

1-800-295-5510  
uline.com

## REPLACEMENT PARTS

#	DESCRIPTION	QTY.	ULINE PART NO.	MFG. PART NO.
1	72" Upright Post	4	H-1523-POST	-----
1	84" Upright Post	4	H-1060-POST	-----
1	96" Upright Post	4	H-1894-POST	-----
2	24" Side Support	1	H-1061-LRA24	-----
3	96" Double Flanged Front/Back Support	1	H-7432-FBSPT	LRC-96-MGY
4	24" Center Shelf Support	1	H-1060-CTR	-----
5	96 x 24" Steel Shelf	1*	H-7432-ADD	-----
6	Hardware Pack (includes 8 nuts and 8 bolts)	1	H-6019	-----
7	Single Flanged Front/Back Support	2	H-1897-BEAM	LRA-96-MGY

\* Each shelf includes 2 side supports, 2 front/back supports, center shelf supports needed for each specific size, 6 nuts and 6 bolts.

**ULINE**

**ESTANTERÍA DE ACERO  
PARA USO PESADO –  
96" DE ANCHO**

800-295-5510  
uline.mx

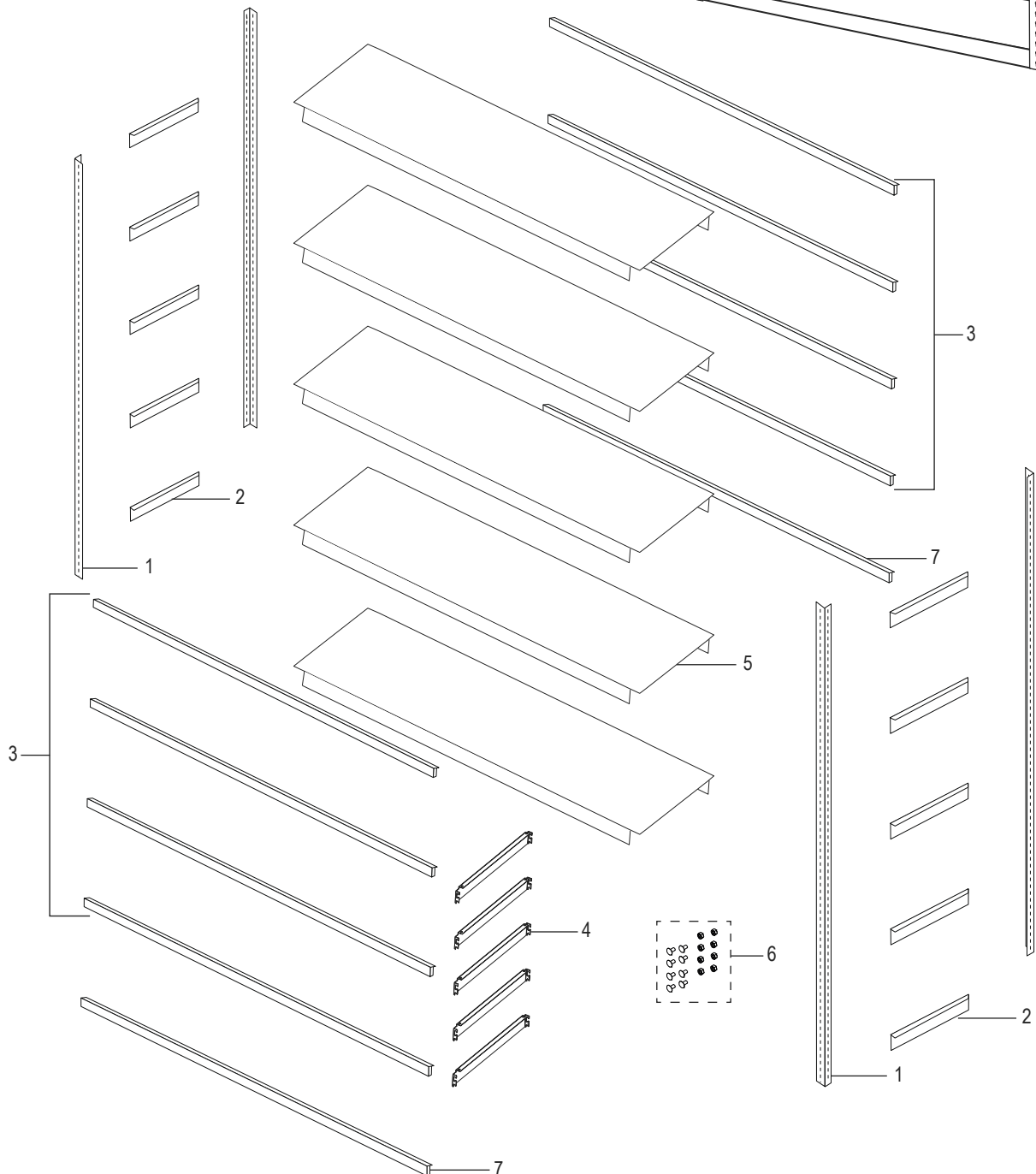
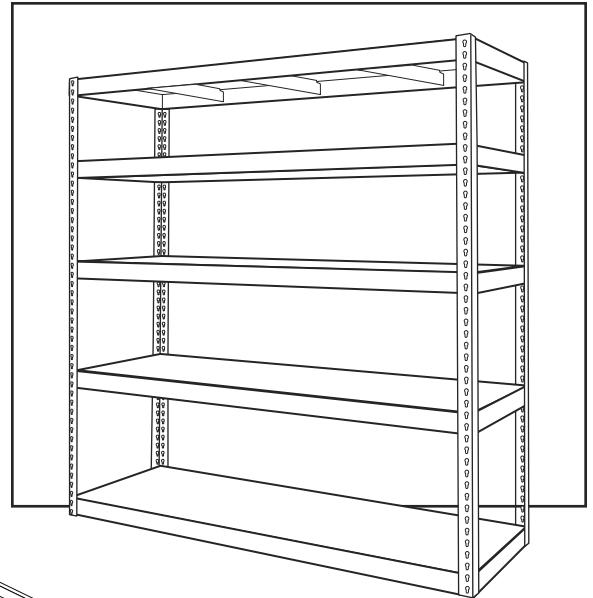

**ESTANTERÍA DE ACERO  
PARA USO PESADO –  
96" DE ANCHO**800-295-5510  
uline.mx

## REPUESTOS

#	DESCRIPCIÓN	CANT.	NO. DE PARTE DE ULINE	NO. DE PARTE DEL FABRICANTE
1	Poste Vertical de 72"	4	H-1523-POST	-----
1	Poste Vertical de 84"	4	H-1060-POST	-----
1	Poste Vertical de 96"	4	H-1894-POST	-----
2	Soporte Lateral de 24"	1	H-1061-LRA24	-----
3	Soporte Frontal/Posterior de 96" con Borde Doble	1	H-7432-FBSPT	LRC-96-MGY
4	Soporte para Repisa Central de 24"	1	H-1060-CTR	-----
5	Repisa de Acero 96 x 24"	1*	H-7432-ADD	-----
6	Paquete de Tornillería (incluye 8 tuercas y 8 pernos)	1	H-6019	-----
7	Soporte Frontal/Posterior con Borde Sencillo	2	H-1897-BEAM	LRA-96-MGY

\* Cada repisa incluye 2 soportes laterales, 2 soportes frontales/posteriores, soportes necesarios para la repisa central según el tamaño, 6 tuercas y 6 pernos.

**ULINE**

**RAYONNAGE EN  
ACIER ROBUSTE –  
96 PO DE LARGEUR**

1-800-295-5510  
uline.ca

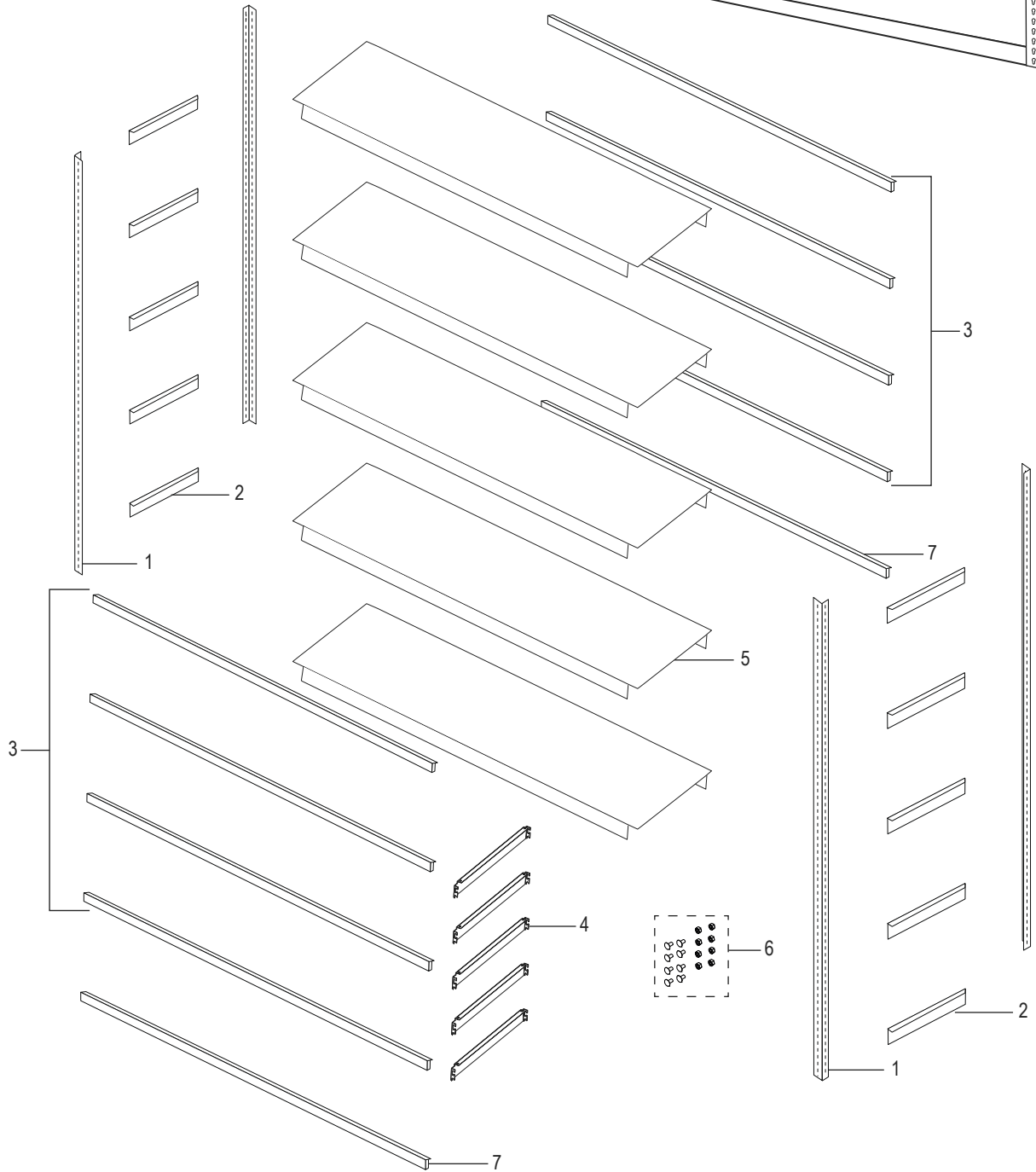
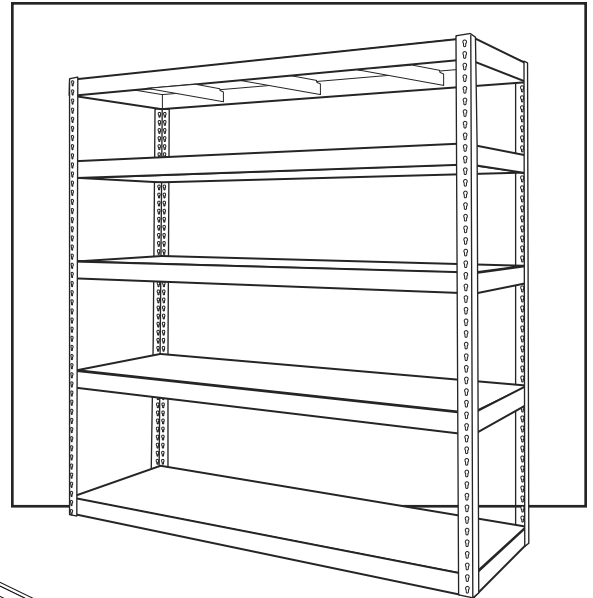

**PIÈCES DE REMPLACEMENT**

#	DESCRIPTION	QTÉ	RÉF. ULINE	RÉF. DU FABRICANT
1	Montant de 72 po	4	H-1523-POST	-----
1	Montant de 84 po	4	H-1060-POST	-----
1	Montant de 96 po	4	H-1894-POST	-----
2	Support latéral de 24 po	1	H-1061-LRA24	-----
3	Support avant/arrière de bride double de 96 po	1	H-7432-FBSPT	LRC-96-MGY
4	Support de tablette central de 24 po	1	H-1060-CTR	-----
5	Tablette en acier de 96 x 24 po	1 po	H-7432-ADD	-----
6	Matériel d'installation (comprend 8 écrous et 8 boulons)	1	H-6019	-----
7	Support avant/arrière de bride simple	2	H-1897-BEAM	LRA-96-MGY

\* Chaque tablette comprend 2 supports latéraux, 2 supports avant/arrière, des supports de tablette centraux nécessaires pour chaque taille en particulier, 6 écrous et 6 boulons.