

PACKAGING AND SHIPPING INSTRUCTIONS

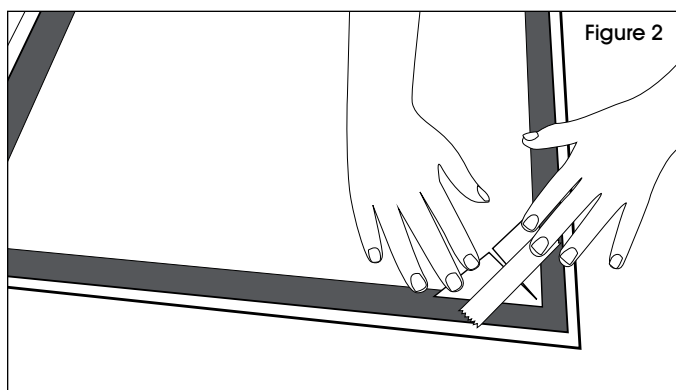
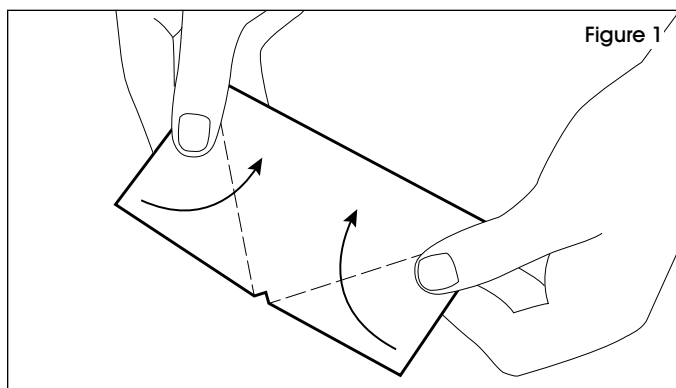

1. Slide the print shipper out of the outer sleeve.
2. Enclosed are four rectangular, perforated corner protectors. Carefully bend the perforation to create a triangle. (See Figure 1)
3. Position the corner protectors on one side of the opened print shipper to accommodate your print.
4. Align the corners of the print to the corners of the corner protectors. Fold the outer corners down to cover the corners of the print. Tape the corner protectors to the print shipper to secure in place. (See Figure 2)
5. Repeat Steps 3 and 4 for the other side of the print.
6. Fold the print shipper closed and slide it back into the outer sleeve. Tape both ends of the outer sleeve.
7. The print is now prepared for safe shipping.