

# ULINE H-878

## PLASTIC TOILET SEAT COVER DISPENSER

1-800-295-5510  
uline.com

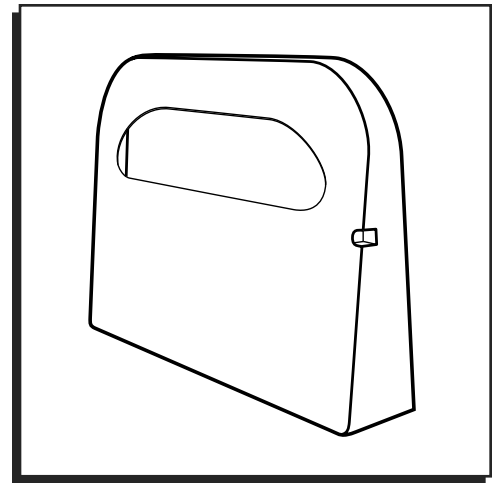

### TOOLS NEEDED



Drill



Drill Bit

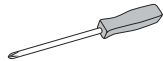

Phillips Screwdriver

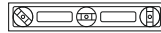

Level

### PARTS

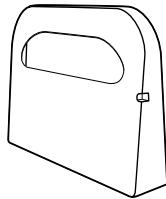

Dispenser x 1



Adhesive Strip x 3  
(already attached)

### MOUNTING INSTRUCTIONS - ADHESIVE STRIPS



**NOTE:** Ensure that proper mounting hardware is used for appropriate wall composition. Adhesive strips may not be compatible with wall surface.

1. Remove backing from adhesive strips. (See Figure 1)
2. Press dispenser firmly onto surface.

Figure 1

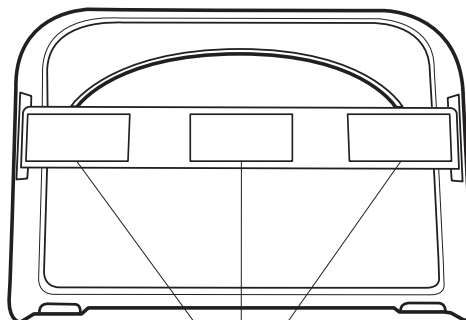

ADHESIVE STRIPS

## MOUNTING INSTRUCTIONS - SCREWS



**NOTE:** Screws are not included with dispenser.

1. Hold dispenser up to desired location and mark two holes on the wall where screws will be inserted. (See Figure 2)

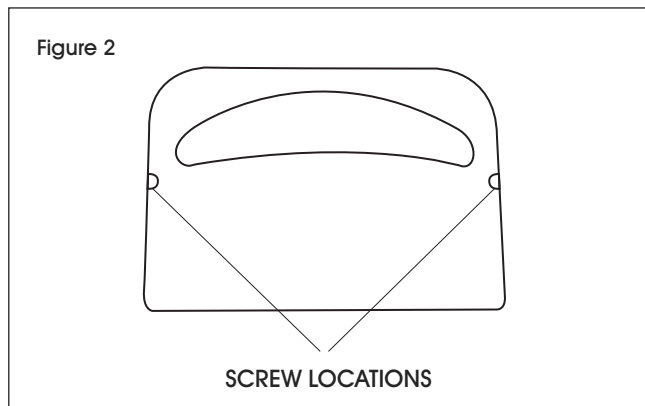

2. Drill into wall at two marked locations with appropriate-sized drill bit. Insert wall anchors if necessary. (See Figure 3)

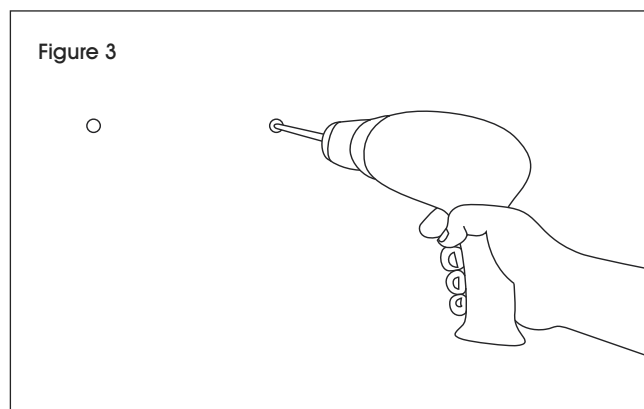

3. Hold dispenser over previously drilled holes and insert screws.

## LOADING INSTRUCTIONS

1. Remove perforated tab from toilet seat cover pack.
2. Insert pack from bottom of dispenser. Push the bottom of the pack towards the front of dispenser to keep it in place. (See Figure 4)

Figure 4

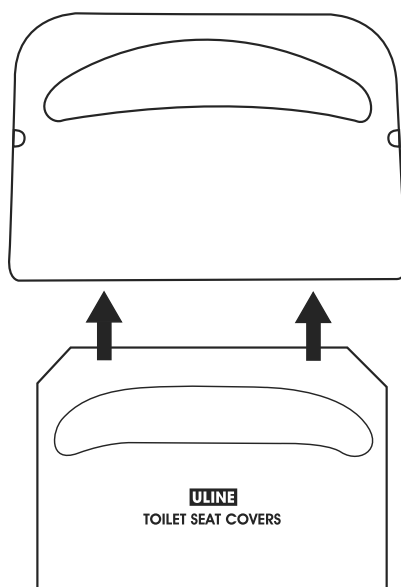

**ULINE** CHICAGO • ATLANTA • DALLAS • LOS ANGELES • MINNEAPOLIS • NYC/PHILA • SEATTLE • MEXICO • CANADA

**1-800-295-5510**

uline.com