

ULINE H-6673
BARCODE SCANNER

1-800-295-5510
uline.com

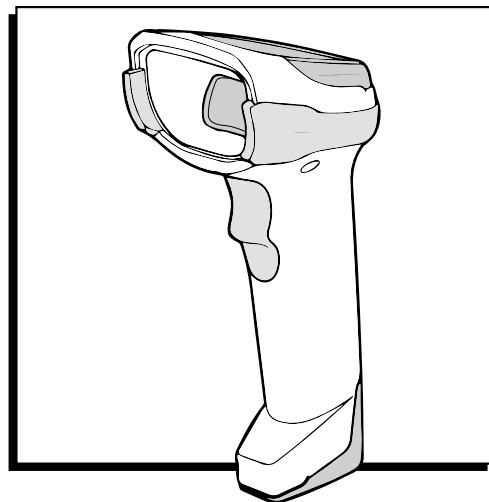

INSTRUCTIONS

1. Connect cradle to host interface. (See Figure 1)

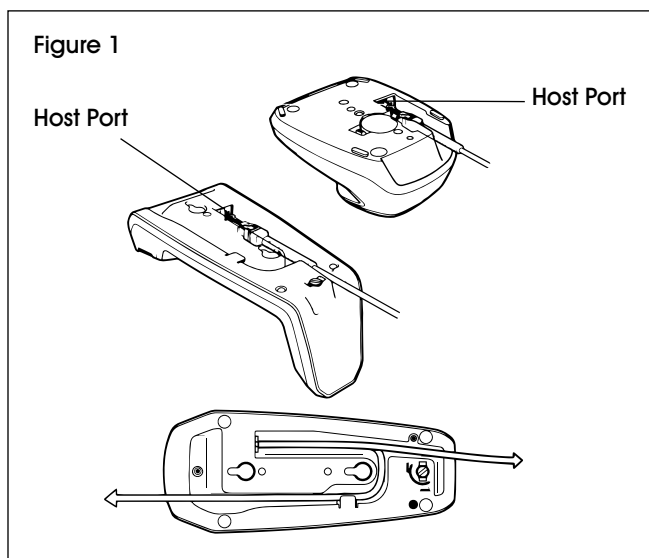

2. Plug adapter into power source and base station. (See Figure 2)

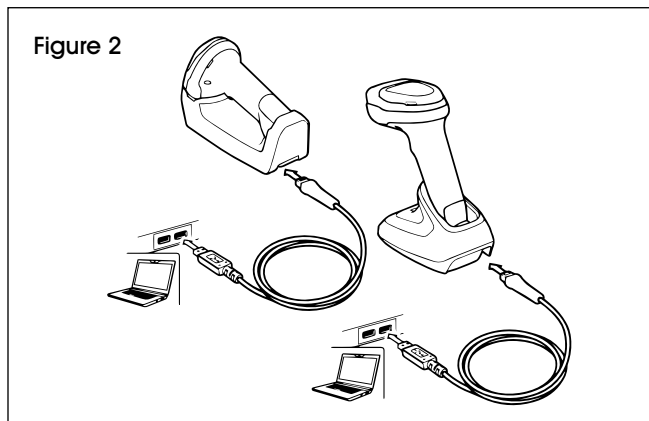

3. Battery insertion/removal. (See Figure 3)

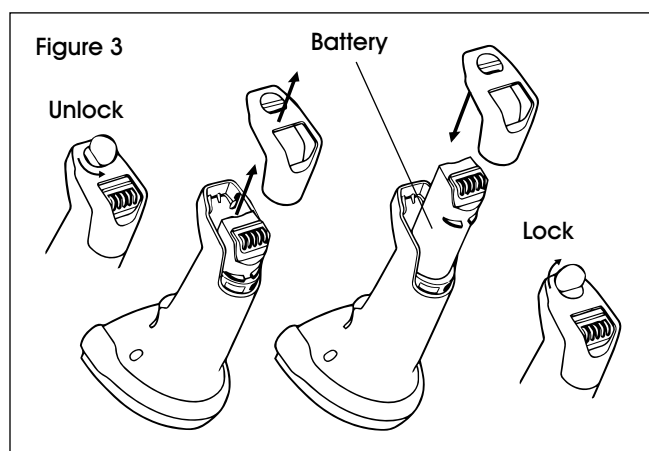

 **NOTE:** For best performance, fully charge the scanner battery before using the scanner for the first time.

4. Scan the appropriate barcode from original Quick Start Guide included in the box.