

**TOOL NEEDED**



PARTS LIST					
<b>A</b>	Glide x 4	<b>B</b>	Metal Handle x 2	<b>C</b>	File Clip x 8
<b>D</b>	Long Aluminum Bar x 2	<b>E</b>	Short Aluminum Bar x 4		
<b>F</b>	Screw x 6 M6 x 40 mm	<b>G</b>	Keys x 1 Set		

**NOTE:** Assemble unit on a smooth, non-marring surface to prevent scratching.

- Check that you have all parts listed.
- 2-person assembly is recommended.

**NOTE:** Part F will be unused if the cabinet is not mounted underneath a desk or credenza shell.

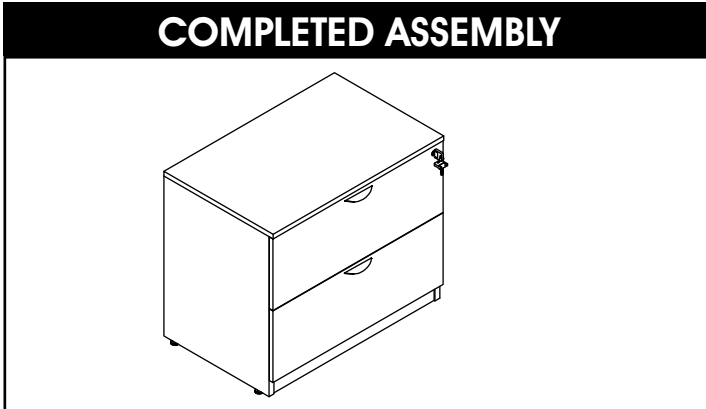

**ASSEMBLY INSTRUCTIONS**

Step 1

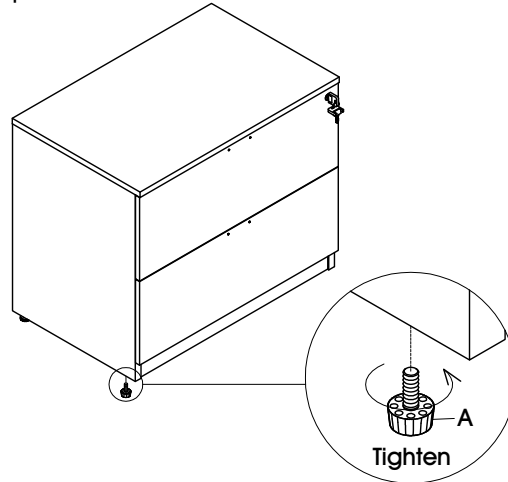

Step 2

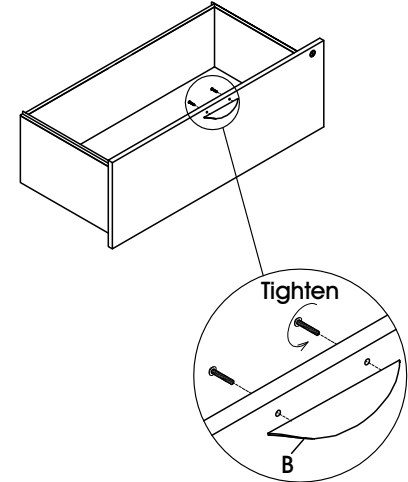

Step 3

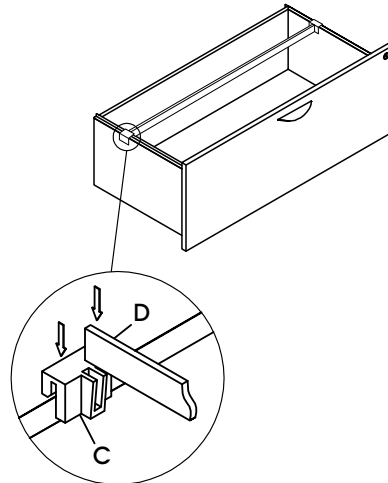

**OR**

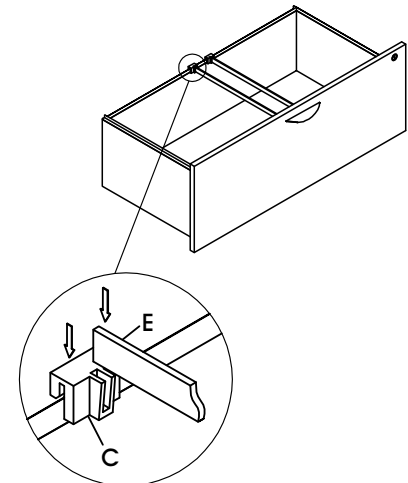

### HERRAMIENTA NECESARIA

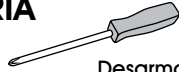

Desarmador de Cruz

### LISTA DE PARTES

A	4 Niveladores	B	2 Asas de Metal	C	8 Clips para Archivos

**NOTA:** Para prevenir rayones, ensamble la unidad sobre una superficie lisa y que no deje marcas.

- Revise que tenga todas las partes listadas.
- Se recomienda ensamblar entre 2 personas.

**NOTA:** La parte F solo se usará si el gabinete se instala debajo de un escritorio o la cubierta de una credenza.

### ENSAMBLE TERMINADO

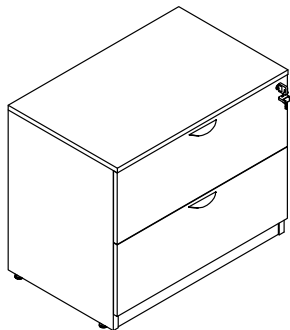

### INSTRUCCIONES DE ENSAMBLE

Paso 1

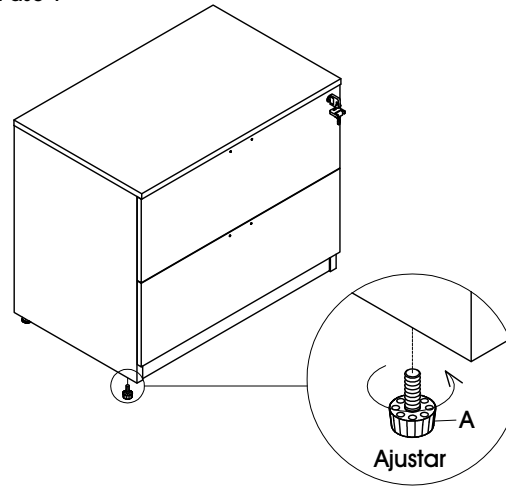

Paso 2

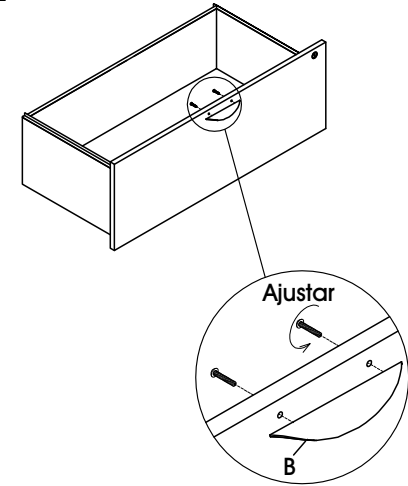

Paso 3

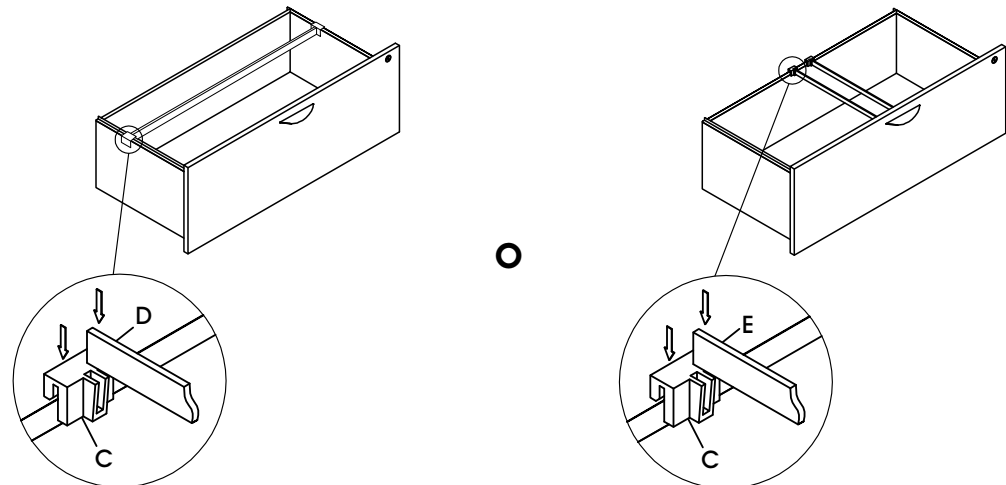

# ULINE H-6304

## CLASSEUR LATÉRAL DE BUREAU – 2 TIROIRS

1-800-295-5510  
uline.ca

### OUTIL REQUIS



### LISTE DES PIÈCES

<b>A</b>	Patin x 4	<b>B</b>	Poignée en métal x 2	<b>C</b>	Clip pour chemise x 8
<b>D</b>	Longue barre en aluminium x 2	<b>E</b>	Courte barre en aluminium x 4		
<b>F</b>	Vis x 6 M6 x 40 mm	<b>G</b>	Ensemble de clés x 1		

**REMARQUE :** Montez l'article sur une surface lisse et non marquante afin d'éviter les égratignures.

- Vérifiez que vous disposez de toutes les pièces énumérées.
- Montage à 2 personnes recommandé.

**REMARQUE :** La pièce F est employée uniquement lorsque le classeur est fixé sous un bureau ou un bahut sans tiroirs.

### MONTAGE COMPLÉTÉ

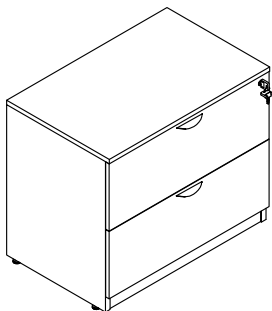

### INSTRUCTIONS DE MONTAGE

#### Étape 1

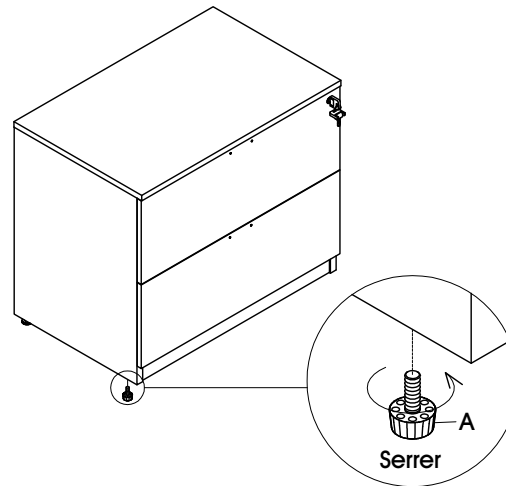

#### Étape 2

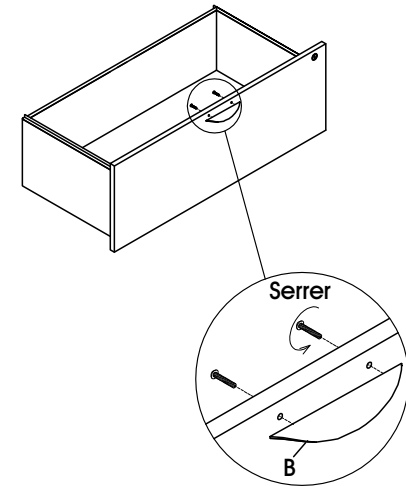

#### Étape 3

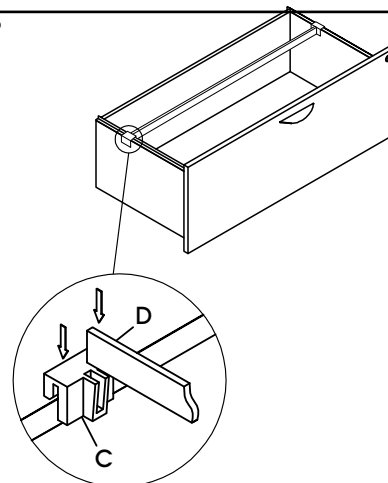

OU

