

ULINE H-1592

CHROME TOILET SEAT COVER DISPENSER

1-800-295-5510
uline.com

TOOLS NEEDED



Drill



Drill Bit

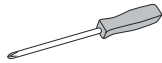

Phillips Screwdriver

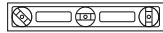

Level

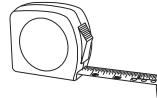

Tape Measure

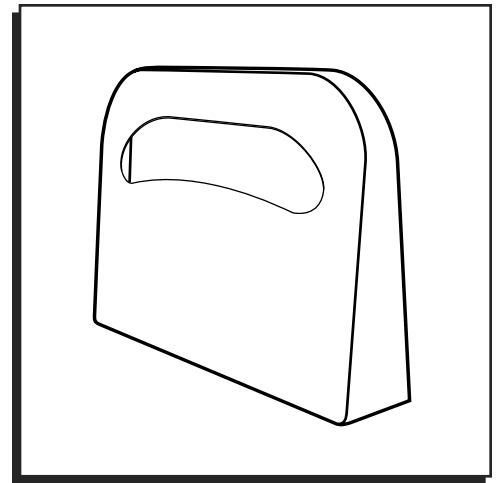

PARTS

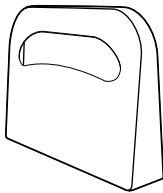

Dispenser x 1



Wall Anchor x 2

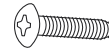

Screw x 2

MOUNTING INSTRUCTIONS



NOTE: Ensure that proper mounting hardware is used for appropriate wall composition. Enclosed hardware may not be compatible with wall surface.

1. Hold dispenser up to desired location and mark two holes on the wall where screws will be inserted. (See Figure 1)

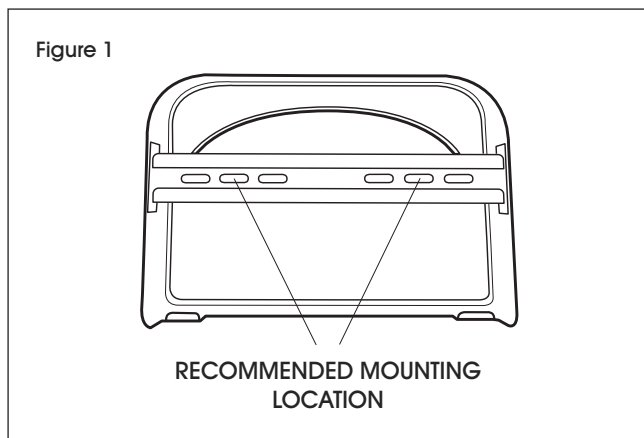

2. Drill into wall at two marked locations with appropriate-sized drill bit. Insert wall anchors if necessary. (See Figure 2)

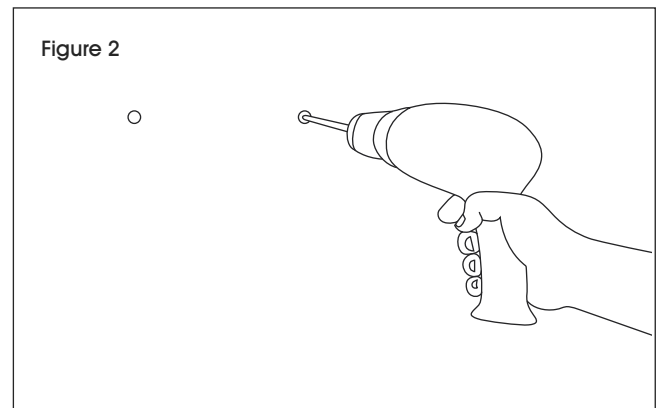

3. Hold dispenser over previously drilled holes and insert screws.

LOADING INSTRUCTIONS

1. Remove perforated tab from toilet seat cover pack.
2. Insert pack from the bottom of the dispenser. Push the bottom of the pack towards the back of the dispenser to keep it in place. (See Figure 3)

Figure 3

