

**ULINE** H-1024, H-1025  
H-1026  
**MANUAL**  
**CARTON STAPLER**

**1-800-295-5510**  
uline.com

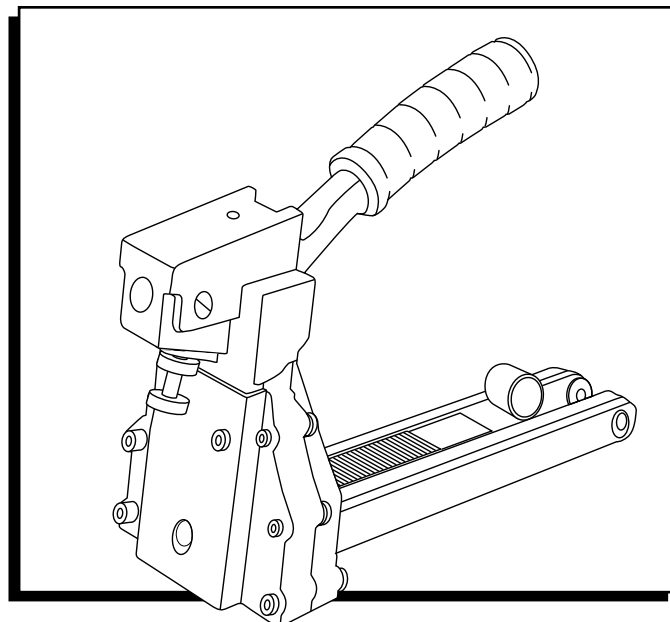

## STAPLER SPECIFICATIONS

Dimensions (L x H x W)	15 x 11½ x 4½"
Weight (Without Fasteners)	3.75 lb.
H-1025/H-1026 Staple Specification	S-289 C58 Stick and/or S-1396 C34 Stick
H-1024 Staple Specification	S-1397 A58 Stick
Staple Capacity	100 Staples

### WARNING

Before operating this stapler familiarize yourself with the safety warnings and instructions in this manual. Keep these instructions with the stapler for future reference. If you have any questions, contact Uline at 1-800-295-5510.

# SAFETY INSTRUCTIONS

## SAFETY INSTRUCTIONS

1. Read the manual and understand all safety instructions before operating the stapler. If you have questions, contact Uline at 1-800-295-5510.
2. Always wear protective equipment; e.g., safety glasses, hearing protection and head protection.
3. Do not place your hand or any other body part in the staple clinching area.
4. Never point the stapler at yourself or anyone else.

## LOADING THE STAPLER

1. Pull the pusher back until it stops on pusher pivots. Rotate pusher to position. (See Figure 1)
2. Insert up to 2 sticks of appropriate staples into the magazine. Let the sticks slide forward to the front of the magazine. (See Figure 2)

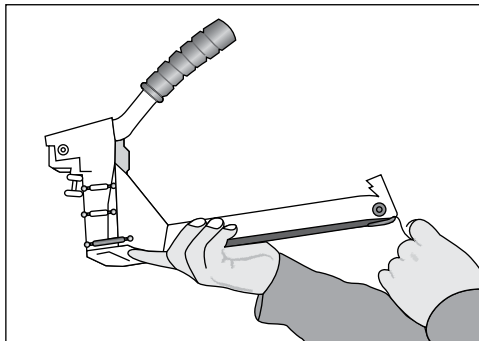

Figure 1

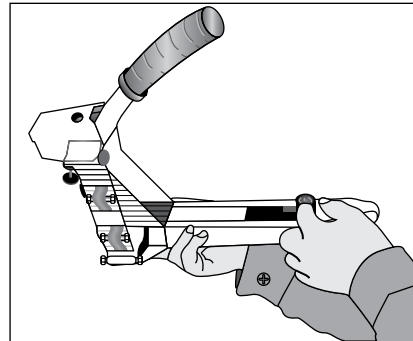

Figure 2

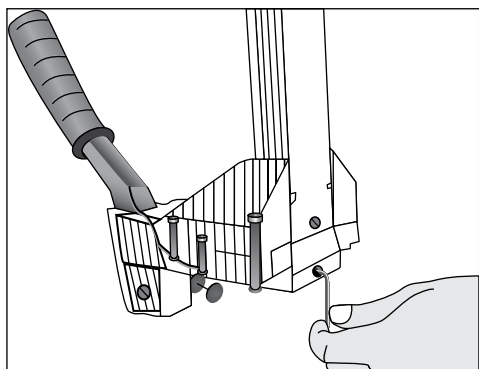

Figure 3

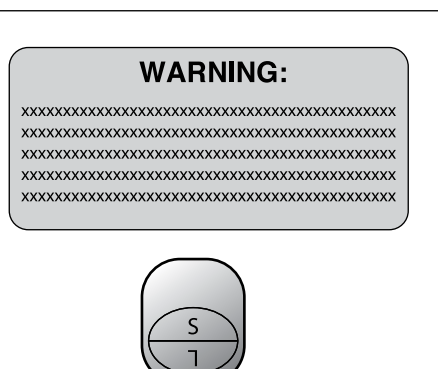

Figure 4

3. Pull the pusher back to an upright position and gently let the pusher slide forward against the staples. Do not let the pusher slide forward and strike the staples at high speed as this may deform the staples and damage the stapler.

## ADJUSTING STAPLE LEG LENGTH

1. Loosen the set screw with a 3mm Allen wrench on the bottom. (See Figure 3)
2. Turn adjusting rod 180° with a screw driver to the desired setting.
3. If you are using 3/4" staples set L up.
4. If you are using 5/8" staples set S up. (See Figure 4)
5. Tighten the set screw.

## SAFETY INSTRUCTIONS (CONTINUED)

### CLINCH ADJUSTMENT

Loosen securing nut closest to body. Turn adjustment nut clockwise to loosen clinch. Turn adjustment nut counter-clockwise to tighten clinch. After adjusting, tighten securing nut. (See Figure 5)

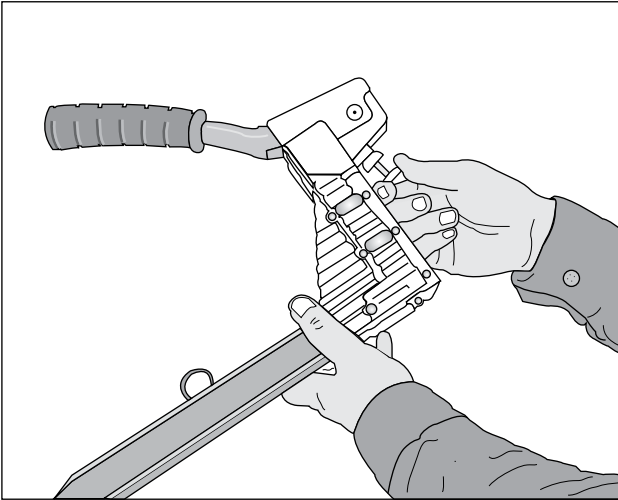

Figure 5

### DEPTH ADJUSTMENT

1. Loosen front 2 screws with a 4 mm Allen wrench. (See Figure 6)
2. Push the body up and adjust to the desired depth. (See Figure 7)

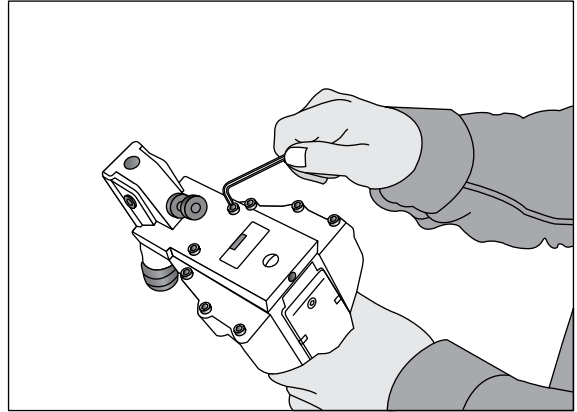

Figure 6

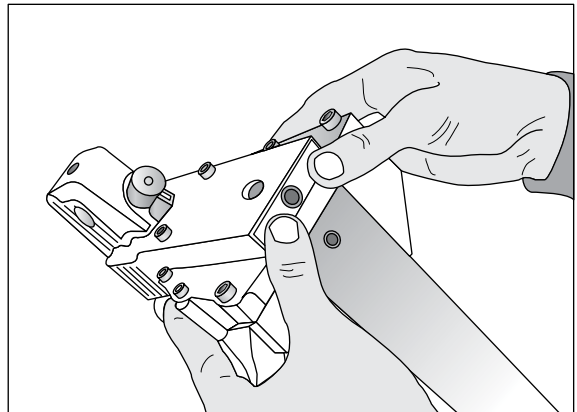

Figure 7

# OPERATING INSTRUCTIONS

## WARNING

1. Protect your eyes and ears.
  - a. Wear safety glasses with side shields.
  - b. Wear hearing protection.
  - c. Ensure that anyone in the vicinity wears safety protection.
2. To prevent accidental injuries, never place a hand or any other body part in the staple clinching area or adjustment window.
3. Never point the stapler towards you or anyone else.
4. Always handle the stapler with care. Never pull the trigger unless stapler is ready for operation.
5. Check and replace any damaged or worn components on the stapler.

## BASIC OPERATION

1. Insert the staples into the stapler following the loading instructions.
2. Grasp the handle with one hand on box in line with the desired staple location. There is a small projection on either side of the magazine seat as an aid in locating the position of the staple.
3. For strongest closure, use staples close to the ends of the box.

## CLEARING A JAM

1. Pull pusher back and rotate to a locked position. (See Figure 8)
2. Insert needle nose pliers or screw driver to clear jam. (See Figure 9)
3. Slowly release pusher back to position.

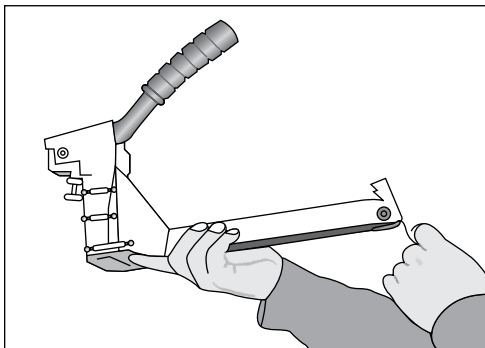

Figure 8

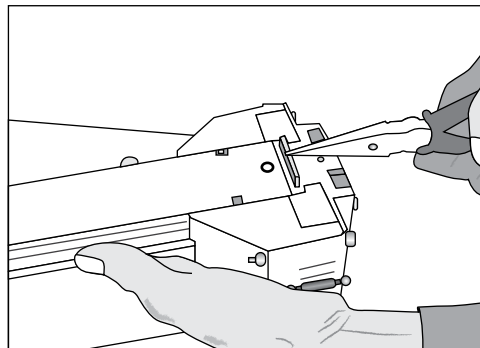

Figure 9

## TROUBLE SHOOTING

### WARNING

Stop using the stapler immediately if any of the following problems occur. Serious personal injury could occur. Any repairs or replacements must be done by a qualified person or authorized service center only.

PROBLEM	CAUSE	REMEDY
Excessive jams	Teeth screws are loose or staples are wrong size.	Tighten screws and check staples.
Uneven clinch	Wrong staple size.	Check for proper leg length adjustment and clincher size.
Unclinched staple	Teeth are loose or broken.	Check and replace teeth as needed.

### TEETH REPLACEMENT

1. Loosen screws and nut with an 8 mm wrench and 4 mm Allen wrench. (See Figure 10)
2. Remove the magazine assembly. (See Figure 11)
3. Loosen screws with 3 mm Allen wrench. (See Figure 12)
4. Change teeth one at a time to prevent reverse teeth.

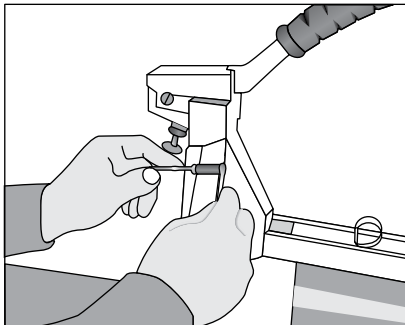

Figure 10

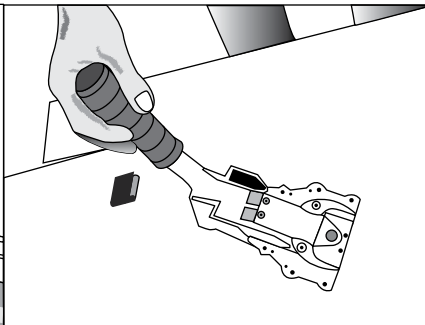

Figure 11

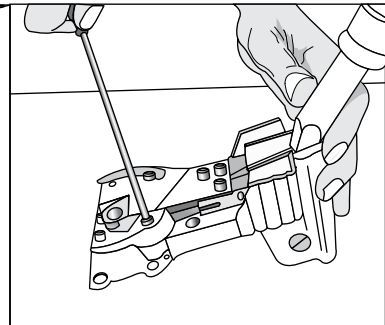

Figure 12

## TROUBLE SHOOTING (CONTINUED)

### DRIVER REPLACEMENT

1. Loosen screw and nut with a 8 mm spanner wrench and a 4 mm Allen wrench. (See Figure 13)
2. Remove the magazine assembly. (See Figure 14)
3. Loosen the set screw with a 3 mm Allen wrench to unlock the adjusting rod. (See Figure 15)
4. Remove the linkage mechanism and adjusting rod simultaneously from the body.
5. Loosen the pivot screws with flat screwdriver. Remove handle and linkage mechanism.
6. Remove the spring pin with a hammer and 5 mm straight rod.
7. Loosen screws with a 3 mm Allen wrench. Take off the spring pin with a hammer and 6 mm straight rod. (See Figure 16)

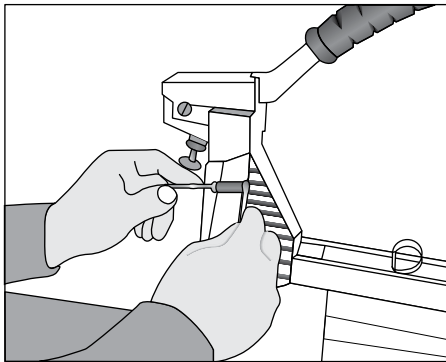

Figure 13

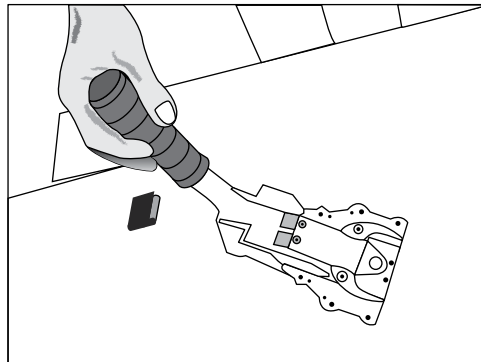

Figure 14

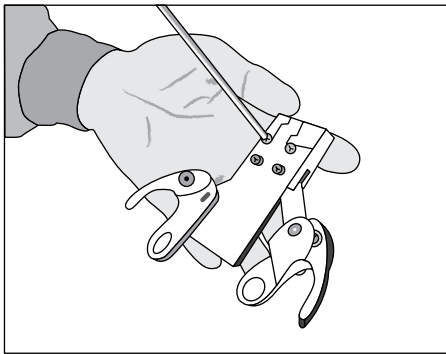

Figure 15

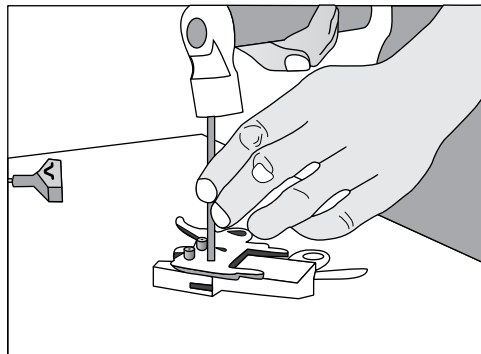

Figure 16

## TROUBLE SHOOTING (CONTINUED)

### PUSHER SPRING REPLACEMENT

1. Loosen the screws and nut with a 8mm spanner wrench and a 4 mm Allen wrench. (See Figure 17)
2. Remove the magazine assembly. (See Figure 18)
3. Pull the pusher back until it stops on the rod, rotate the pusher to position.
4. Push the magazine seat back and remove it from the magazine.
5. Loosen the screw and nut with a 2.5 mm Allen wrench and 7mm socket wrench. (See Figure 19)
6. Loosen the rod with a 6mm offset wrench and remove the pusher guides. Remove the pusher. (See Figure 20)
7. Remove the spring pin with a hammer and 4 mm straight rod. (See Figure 21)

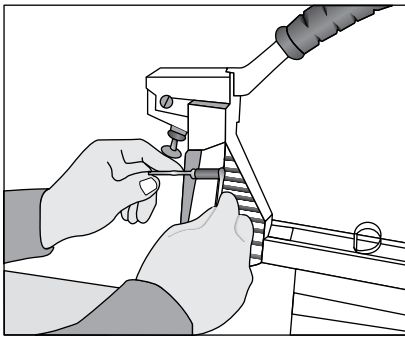

Figure 17

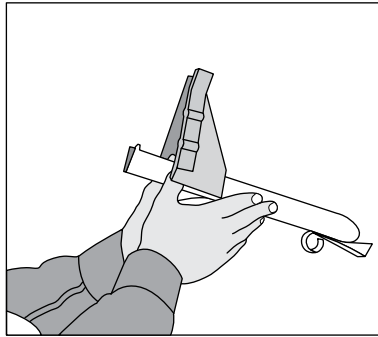

Figure 18

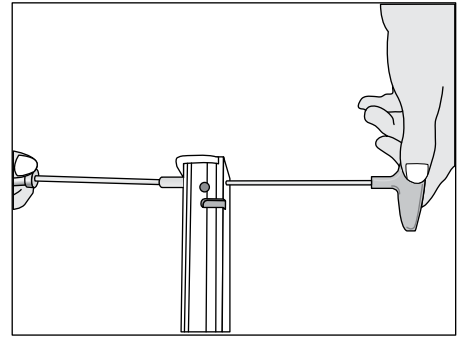

Figure 19

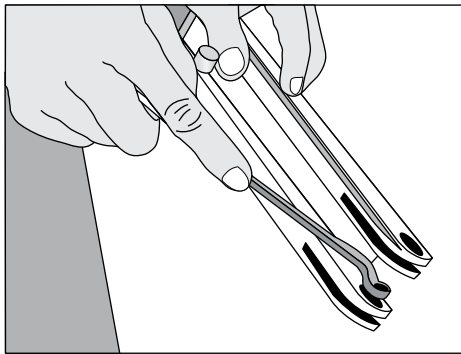

Figure 20

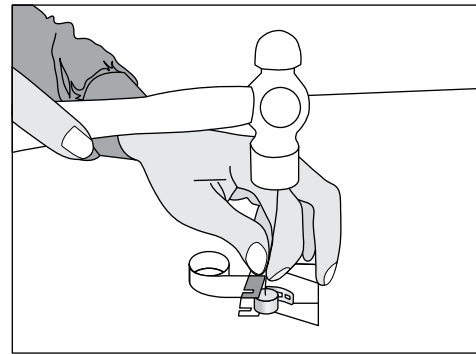

Figure 21